

Specification Sheet SS-ASW

Air Sweeper

Features & Benefits

- Fresh air movement can be created anywhere in the workspace
- Long distance air throw
- Large volume air movement 15 times input volume
- Very low energy consumed



Technical Data

Model	Nominal Airflow	Velocity@nozzle	Noise Level @3m	Motor Power	Power Supply	Total Airflow
						ER : 15
CJ 210	1200 CMH	13 m/s	59 dB (A)	150 W	1ø 220 V 50 Hz	22,500 CMH
CJ 270	3058 CMH	15 m/s	65 dB (A)	300 W	1ø 220 V 50 Hz	52,500 CMH

ER : Entrainment Ratio

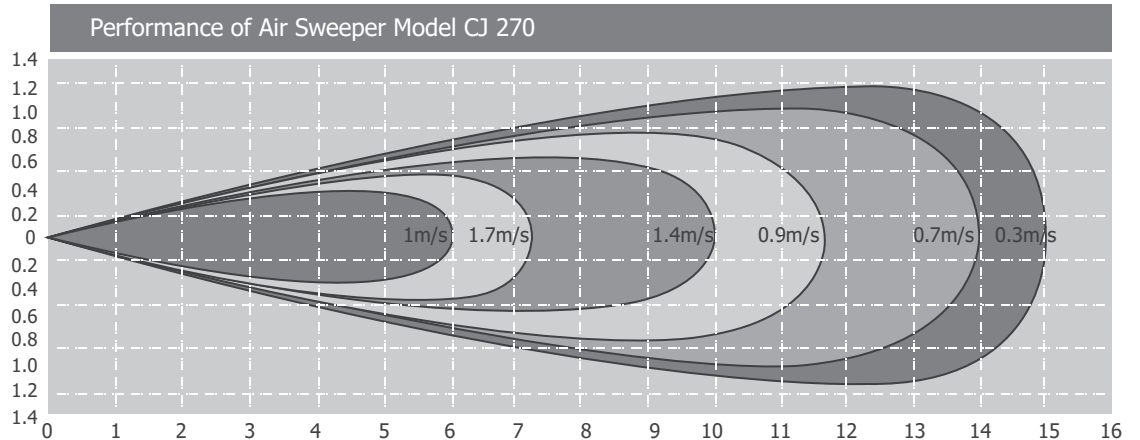
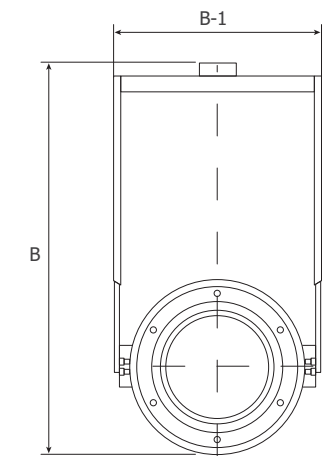
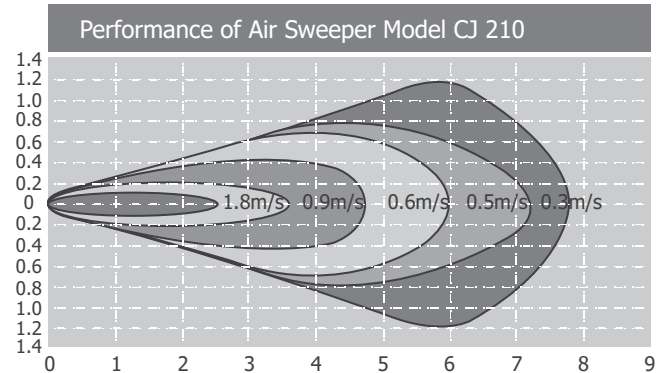
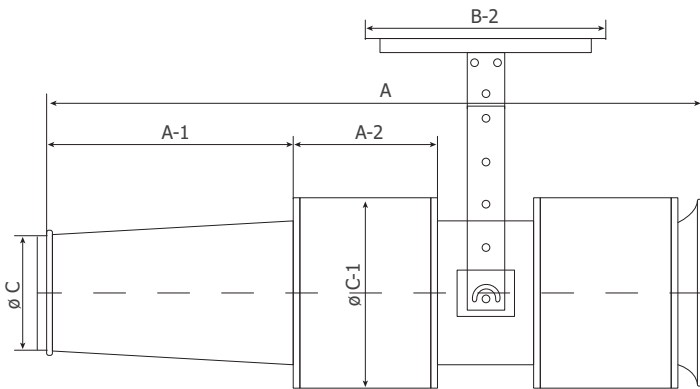

Dimensions & Weight

Model	A	A-1	A-2	B	B-1	B-2	ø C	ø C-1	Kg
CJ 210	960	375	200	675~900	350	380	170	270	16
CJ 270	1385	550	300	735~960	444	470	250	392	30